

Easthaus



— Offers in Excess of £700,000



— Terraced House



— 2 Bedrooms



— 1 Bathroom



— Circa 650 sqft

Speldhurst Road, Victoria Park Village, Hackney E9

Rare to the market, in a coveted East London location: Speldhurst Road is in the heart of Victoria Park Village, and this 2-bedroom freehold house boasts a south-west facing private garden and a front drive.



Easthaus



Interior:

The ground floor comprises a living room with space for dining and home working, a private garden, kitchen with gas hob and a double-glazed wood framed window, and an understairs storage cupboard.

Stairs lead up to the first floor providing two double bedrooms, both with space for storage, and the main bedroom overlooks the garden to the rear; there is a tiled bathroom and further storage cupboard in the hall.

Outside Space:

Sliding patio doors open from the living room onto a garden with patio area. Benefitting from a south/west aspect, the garden will attract a great amount of sunshine, making the space perfect for summer afternoons and evenings entertaining.

This house further benefits from circa 300sqft of loft space/storage space, and a front drive for off street parking.

Area

Victoria Park Village is arguably east London's most desirable neighbourhood. The retail offering in the village is second to none, with favourites like Village Organic, Gails bakery, Ginger Pig butchers, and Bottle Apostle bottle shop all on your doorstep. Easthaus favourite Pophams bakery and coffee shop is just around the corner, as well as Hackney favourite The Empress pub and kitchen, ever-present here since the late 1800s. Nearby Well Street also offers some great dining options with Paulie's for delicious New York style bagels, The Gun public house for spicy margaritas and food by Rake – you truly are spoilt for choice. Victoria Park and Regents Canal are just a short walk away, with London Fields and Broadway Market circa 15 mins walk. There are endless options for pubs, shops and cafes all by foot, it is truly one of London's villages. London Fields overground station is within easy reach (circa 0.5 miles), Homerton overground station is also just 0.7 miles away. There are a number of well-connected bus routes run from surrounding Mare Street, Well Street and Victoria Park Road. Plus great schools in the neighbourhood include Orchard Primary School, Lauriston Primary School and Mossbourne Academy.

Details

Tenure: Freehold

EPC Band D

Council Tax: LB Hackney Band D



Easthaus



Easthaus



Easthaus

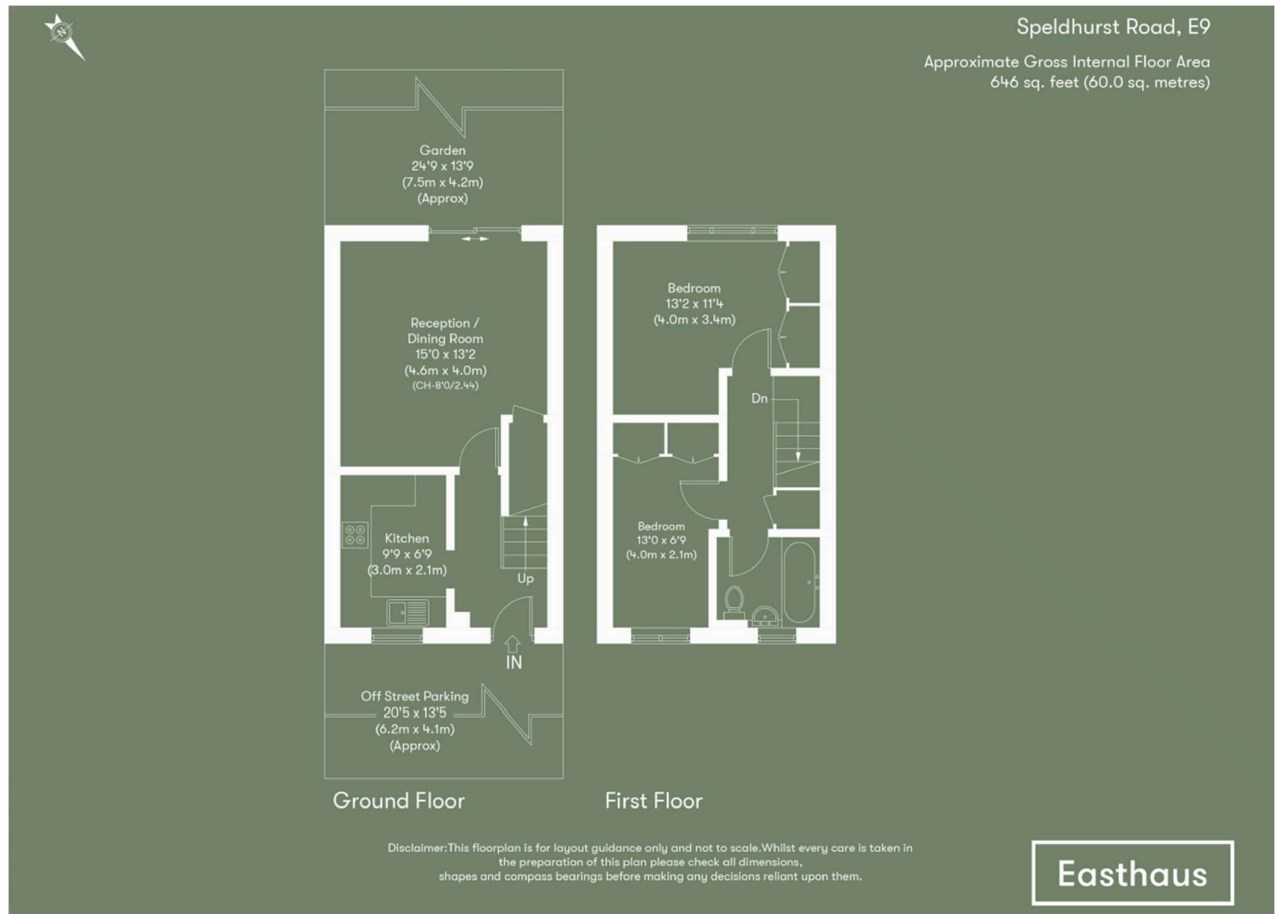

Important notice:

1. Particulars: These particulars are not an offer or contract, nor part of one. You should not rely on statements by Easthaus Limited in the particulars or by word of mouth or in writing ("information") as being factually accurate about the property, its condition or its value. Neither Easthaus Limited nor any joint agent has any authority to make any representations about the property, and accordingly any information given is entirely without responsibility on the part of the agent(s), seller(s) or lessor(s). 2. Photos and floorplans: The photographs show only certain parts of the property as they appeared at the time they were taken. Areas, measurements and distances given are approximate only. 3. Regulations, etc.: Any reference to alterations to, or use of, any part of the property does not mean that any necessary planning, building regulations or other consent has been obtained. A buyer or lessee must find out by inspection or in other ways that these matters have been properly dealt with and that all information is correct. 4. VAT: The VAT position relating to the property may change without notice. 5. Particulars dated 2nd December 2024. EastHaus Limited is registered in England with registered number 10275389. Our registered office is The Oast, New Road, East Malling, Kent, ME19 6BJ.

